

DA33022 23W

DA33033 31W

Series

High Efficiency

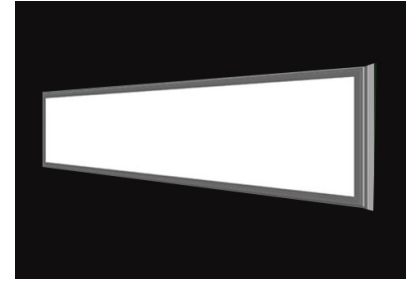

Features

- Equivalent to 1200x2' T8 Tube, fluorescent ceiling fixture
- High Power Factor >0.9
- High CRI. High Efficiency
- For ceiling drop-in, Plaster Frame mounting, Surface mounting or suspended mounting.
- 5 years warranty

Benefits

- Extra Long Life More than 50,000 hours. LM80 LM79
- Save upto 80% of energy Consumption & reduce maintenance costs
- Virtually no heat or UV output
- No Mercury & Resistant to Shock and vibration

Specification

Model Number	DA33022-1230/DA33022-6060 23W , DA33033-1230/DA33033-6060 31W
Light Source	SMD LED LM80 Available SDCM<3
Lens Finish	High efficiency frosted cover and No Glare Cover available
Efficiency	Up to 120L/W
Color Temperature (CCT)	4000±200K
Dimensions (mm)	1230:(L)1195x(W)295x(H)12 / 6060:(L)595x(W)595x(H)12
Thickness and Weight	Ultra Slim with 12MM thickness 3Kg
Color Rendering index (CRI)	>80 OR >90
Power Consumption	23W and 31W
Standard Finish	White or Silver
IP Rated	IP44, IP54 and IP65 Available
Glare Factor	UGR<19
Light Beam Angle	120 degree
Driver Option	No Flickering and Dali Dimmable Available

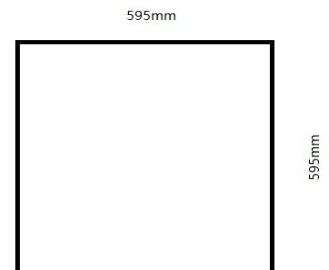

Optical Performance

Code: DA33022DA33033

This test is based on 4000K

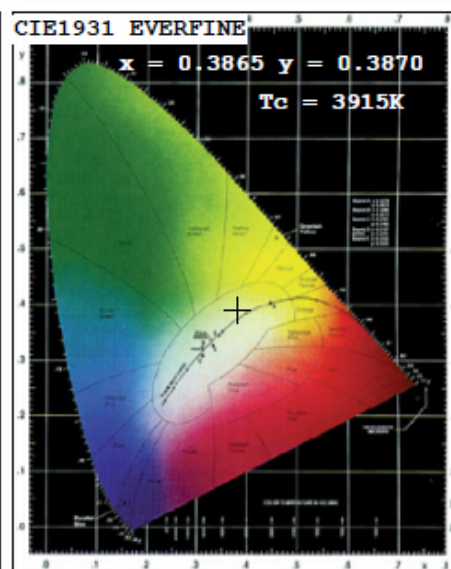
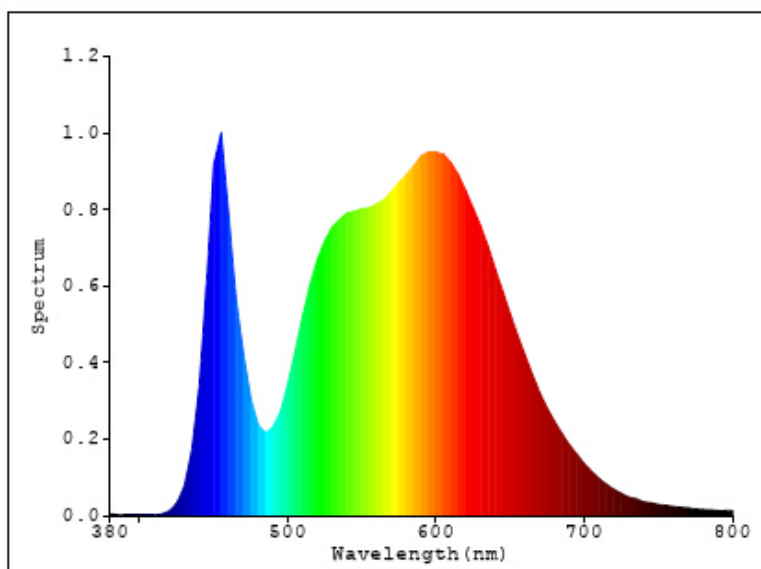

Color Parameters:

Chromaticity Coordinate: $x=0.3865$ $y=0.3870$

Chromaticity Coordinate: $u'=0.3865$ $v'=0.3870$ ($duv=2.99e-03$)

$T_c=3915K$ Dominant WL: $L_d=577.9nm$ Purity=32.1% Centroid WL: $573.0nm$

Ratio: $R=20.1\%$ $G=77.1\%$ $B=2.8\%$ Peak WL: $L_p=455.0nm$ HWL: $24.1nm$

Render Index: $R_a=82.9$

$R_1 = 82$ $R_2 = 88$ $R_3 = 91$ $R_4 = 83$ $R_5 = 80$ $R_6 = 82$ $R_7 = 88$

$R_8 = 68$ $R_9 = 14$ $R_{10} = 69$ $R_{11} = 80$ $R_{12} = 52$ $R_{13} = 83$ $R_{14} = 95$ $R_{15} = 76$

DATA OF LAMP		PHOTOMETRIC DATA				Eff: 115.87 lm/W
MODEL		$I_{max}(cd)$	1871	S/MH(C0/180)		1.18
NOMINAL POWER(W)		LOR(%)	100.0	S/MH(C90/270)		1.11
RATED VOLTAGE(V)		TOTAL FLUX(lm)	3534.2	η UP,DN(C0-180)		0.1,50.8
NOMINAL FLUX(lm)	3534.16	CIE CLASS	DIRECT	η UP,DN(C180-360)		0.1,49.1
LAMPS INSIDE	1	η up(%)	0.1	CIBSE SHR NOM		1.00
TEST VOLTAGE(V)		η down(%)	99.9	CIBSE SHR MAX		1.15

Installation

Code: DA33022DA33033

Accessories for Surface Mounted



Installation Step:

1st step



2nd Step

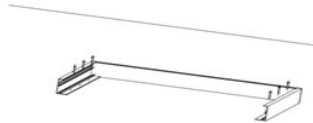

3rd Step



4th Step



For Suspension Purpose



Plaster Frame cutout Size: **1208mmX309mm**

615mmX615mm

PLASTER FRAME INSTALLATION

Step 1 : Cut out aperture to suit Plaster Frame

Step 2 : Hold Frame up against Plaster , Screw Through Plaster frame into Timber Batten.

Step 3 : Push fitting up through Plaster Frame , plug in and drop down into Frame.

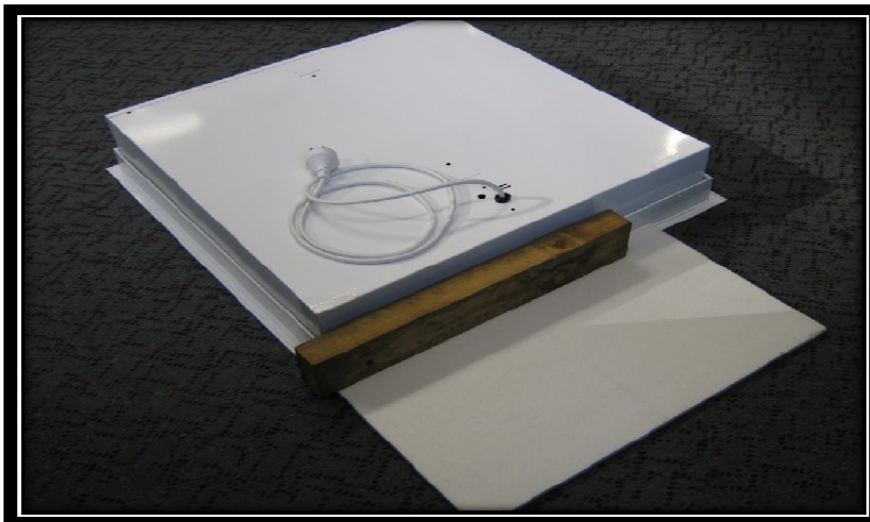

Applications

Offices

- Conference Centers
- Retail Outlets
- Schools
- Hotels
- Hospitals
- Airports
- Sports Facilities
- Parking Areas



Restrictions

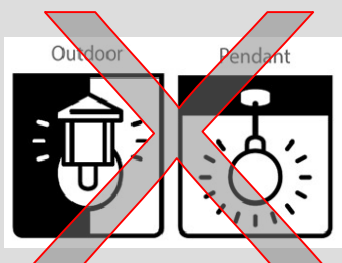

- For Indoor Use Only.
- Do not use in sealed Fixtures.

